

AHTS "SEA BASS" SHIP'S PARTICULAR



General	
Vessel name	SEA BASS
Owner	Neo Marine Service International DMCC
Year Built	12 April 2013
Year Keel Laid	27 July 2012
Yard	Fujian Southeast Shipbuilding Co LTD
Place of build	Fuzhou , China
Flag	Azerbaijan
IMO No.	9655676
Call sign	4JUI
Length (OA) X Breadth	59.85 M X 14.95 M
Length (BP)	52.80 M
Moulded depth	6.10 M
Design Draft	4.75 M
Extreme Draft	5.014 M
Freeboard	712 MM
Air Draught	23.90 M
Gross Tonnage	1727 GT
Net Tonnage	518 GT
Lightship	1598.849 T
Fully Loaded (DEAD WEIGHT)	1401.260 T
Fully Loaded Displacement	3000.109 T
Joystick – DP Class (1/2/3)	DP1 , Kongsberg K-Pos DP11 / cJoy
Class	RINA C ⚡ Offshore Support Vessel , fire-fighting ship-1 unrestricted navigation ⚡ DYNAPOS DP1 ; INWATERSURVEY
Propulsion/Maneuverability	
Total power of Main Engines	2 X 2575 BHP (2 X1920 kW)
Main Engines Number and Type	2 X Caterpillar 3516CHD
Total power of Diesel generators	2 X 350 KW
Diesel generators Number and Type	2 X Caterpillar C18
Total power of Shaft Generators	2 x 800 KW
Shaft Generators Number and Type	2 x Leroy Somer LSAM 50.2M6C65/4
Total power of Emergency Generators	1 X 65 KW
Emergency Generators Number and Type	1 X Caterpillar C4.4
Total power of Bow Thruster	1 X 515 KW
Bow Thruster Number and Type	1 x Wuhan Kawasaki KT-72B3
Total power of Stern Thruster	1 X 515 KW
SternThruster Number and Type	1 x Wuhan Kawasaki KT-72B3
Propeller Type	2 x Twin screw Scoda 40L/min
Cargo Capacities	
Max Clear Deck Space m2	130 SQM
Max Clear Deck Length and Breadth (mxm)	13.50 M x 11.80 M
Deck Strength	7 T / SQM
Max Deck Cargo (tonnes)	500 T
Electrical points on deck for reefer containers	4 x 415V, 2 x 220V
Fuel Oil tanks m3	476 CU M (12 pcs tank)
Potable Water tanks m3	211.9 CU M (6 pcs tank)
Drill Water tanks m3	423.8 CU M (9 pcs tank)

Recovery Oil tanks m3	770.8 CU M (9 pcs tank)
Foam tanks m3	11.3 CU M (1 pcs tank)
Detergent tanks m3	11.3 CU M (1 pcs tank)
Dry Bulk	85 CU M (2 pcs tank)
Pumps	
Fuel Oil	1 X 150m3/hr Azcue BTDG110T-F
Fresh Water	1 X 125m3/hr Azcue CM/EP100/26
SWB/Drill Water	1 X 100m3/hr Azcue CM/EP80/26A
Bilge pump	1 X 75m3/hr Azcue CA100/80-40A
Fire pump	1 X 75m3/hr Azcue CA100/80-40A
Bulk Cement	2 x 13m3/min @ 5.9 bar Tanabe TASK-2575FW-E

Fire Fighting Equipment	
Fire fighting – 1/2/3/ Portable Pack (please state)	FIFI CLASS 1
Fi-Fi Pumps	2 X 1650 CU M / HR SFP250/350XP
Monitors – Water/Foam	2 X 1200 CU M / HR
Foam/Detergent	1 x 11.3 CU M tank
Emergency Fire Pump	35 CU M / HR @ 4.5 BAR
DP system	
DP system type	Kongsberg , K-Pos DP11 / cJoy
DP Reference System	1 x Radius 1000 , 2 x DGPS Kongsberg DPS110 and DPS232
DP MRU	1 x Seatex MRU , MRU5
DP GYRO	2 x Anchutz STD 22
DP Anemometer	2 x Young Wind Tracker Model :06206
Speed (details abt and wog)	
Speed (max)	Abt 12.5 knts
Speed (service)	Abt 10.0 knts
Consumption/day at Speed (max)	Abt 12.0 mts
Consumption/day at Speed (service)	Abt 7.0 mts
Consumption/day at port	Abt 1.0 mts
Consumption/day on DP	Abt 4.0 mts
Fuel	MDO as per ISO 8217 DMX + DMA
Deck Equipment	
Anchor Windlass	B.L 37.1 T
Anchors	2 x 1296 kg
Anchor chains	2 x 8 shackles (36 mm)
Capstan	2 x 5 T
Tugger Winch (number/capacity/rating)	2 x 5 T
Crane	3 T SWL @ 9 m
Oil Spill Response	
Work Boat: 6 person	WEEDO 910 TUG
Skimmer Head	Capacity: 115 m3/h @ 50.000 cSt (emulsion) - Hi-Visc 125 TransRec
Skimmer Head	Capacity: 250 m3/h @ 1,0 cSt - Weir 125 TransRec
TransRec Storage- and handling Floating umbilical	80m - TransRec 125
Oil Boom Winch	SMV Hydraulic AS LW 25.02
Oil Boom Winch	SMV Hydraulic AS LW 16.11-2-5
Steam generator	GAVARDO CALDAIE SRL OMG 1200
Sanitary container	1
RO tanks	6 tanks - 489.6 m3

Detergent tank	1 tank - 11.3 m ³
Oil Dispersant Spray Boom	2 x 6 meter
Oil Spill detection Radar	1 x Sigma S6
IR CAMERA	1 x APTOMAR SECurus PA00001
Searchlight system UV-light	2 x ColorLight AB CL35
Radio remote control system -	1 x MC-3300EX
Doppler Log Communication buoy -	1 x Aanderaa data instruments AS 4589
Doppler Log Bouy	1 x Aanderaa data instruments AS 4589
Rescue and Recovery	
FRC	6 person , WJ45KR
FRC Davit	21 KN/3.75 Single arm davit HMD21
Life rafts	6 x for 25 persons each CRVF-A-25
LSA	42
Accommodation	
Single Berth Cabins	8
Double Berth Cabins	7
Hospital	1
Total Berths	22
Radio and Navigational equipment	
Radars	2 x Radar Furuno FAR 2117
Radio MF/HF	2 x FURUNO FS-2575C and SAILOR 6301
Radio VHF	2 x Furuno FM 8800S
Portbale VHF GMDSS	3 x NSR NTW-1000
Portable VHF	3 x Standard Horizon HX400
Satellite phone	1 x Iridium
Portable UHF for Fire-Fighter team	2 x Sailor SP3530
Gyro Compass	2 x Anchutz STD 22
Magnetic compass	1 x REFLECTA/3
GPS	1 x Furuno GP 150
AIS	1 x Furuno FA150
Navtex	Furuno NX -700A
Echo Sounder	1 x FURUNO FE700
Speed log	1 x Furuno DS-80/DS-81
Autopilot	1 x ANSCHUTZ NautoPilot NP60
Weather fax	1 x FURUNO FAX408
Anemometers	2 x Young Model 06206
EPIRB	1 x MC MURDO E5 SMARTFIND 406 EPIRB
Radar Transponders	2 x Kannad Marine Rescuer 2 SART
Inmarsat C (Telex/Telefax/Email)	2 x Furuno Felcom 15
ViSAT	1 x KVH Mini-Vsat broadband

Particulars are believed to be true and correct and subject to revision without prior notice. Interested parties must inspect vessel to check on suitability. Optional items are to be mutually agreed for inclusion/exclusion in vessel specifications.

These details of the vessels particulars vital and incorporated to any contract and are given in good faith.

107-06-JUN-2017

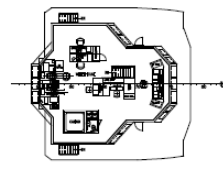
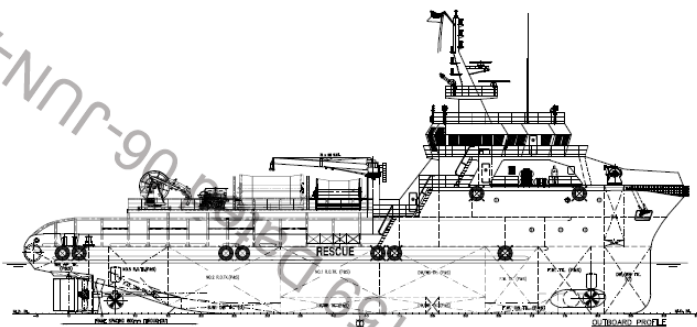

OIL HANGING SPACES ON DECK ARE TO BE PROVIDED WITH A COAMING AROUND ALL PUMPS, TRANSFER FLANGES AND OTHER CONNECTIONS WHERE LEAKAGE MAY BE EXPECTED, THIS COAMING IS TO HAVE A HEIGHT OF AT LEAST 100MM. WHERE DRAINS ARE PROVIDED FOR THE COAMING, CLOSING DEVICES FOR THESE DRAINS ARE TO BE PERMANENTLY ATTACHED.

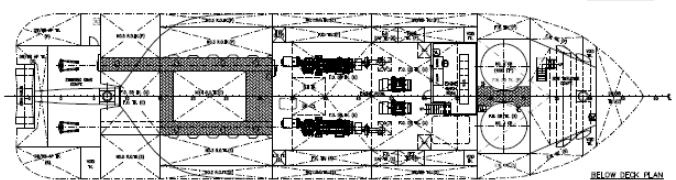
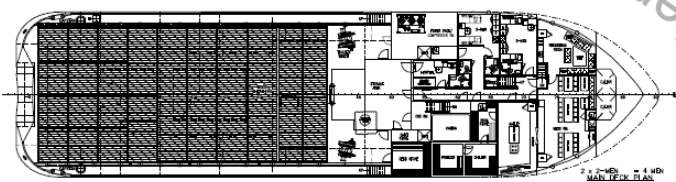
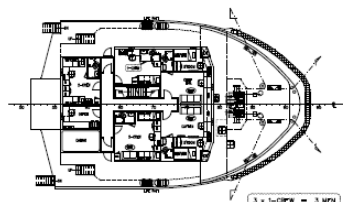
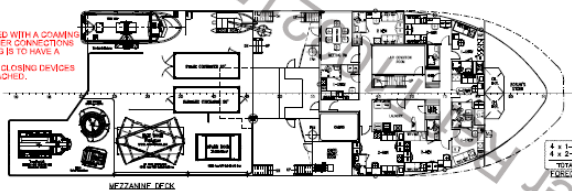

SEE COMMENT PAGE N LETTER.



"VEGA INRUDA"

PRINCIPAL DIMENSIONS

LENGTH (O.A.)	38.850 M
LENGTH (W.L.)	27.800 M
LENGTH (S.P.)	14.550 M
BEAM (M.D.)	6.100 M
DEPTH (M.D.)	4.750 M
DESIGN DRAFT	4.25 M
FUEL OIL	210 M ³
FRESH WATER	420 M ³
DRILL WATER / AIR	420 M ³
RECOVERY OIL (FLASH POINT ABOVE 60°C)	750 M ³
DRY BULK TANKS (DISC'D FT ³)	58 M ³
CLEAR DECK AREA	150 M ²
DECK CARGO (DECK LOADING = 77/M ²)	500 TONS
MAIN PROPULSION ENGINE	2 x 2575 SHP
SPEED (CRUIS.)	14.5 KNOTS
COMPLEMENT	23 MEN

THIS DOCUMENT AND THE INFORMATION IT CONTAINS IS CONFIDENTIAL AND NOT TO BE DISCLOSED TO ANY OTHER PARTY WITHOUT THE WRITTEN PERMISSION OF KHAM CHUAN MARINE PTE LTD. IT IS NOT TO BE USED IN ANY OTHER PROJECT WITHOUT THE WRITTEN PERMISSION OF KHAM CHUAN MARINE PTE LTD.

NO.	1	APPROVED BY	DATE
NO.	2	APPROVED BY	DATE
NO.	3	APPROVED BY	DATE
NO.	4	APPROVED BY	DATE
NO.	5	APPROVED BY	DATE
NO.	6	APPROVED BY	DATE
NO.	7	APPROVED BY	DATE
NO.	8	APPROVED BY	DATE
NO.	9	APPROVED BY	DATE
NO.	10	APPROVED BY	DATE
NO.	11	APPROVED BY	DATE
NO.	12	APPROVED BY	DATE
NO.	13	APPROVED BY	DATE
NO.	14	APPROVED BY	DATE
NO.	15	APPROVED BY	DATE
NO.	16	APPROVED BY	DATE
NO.	17	APPROVED BY	DATE
NO.	18	APPROVED BY	DATE
NO.	19	APPROVED BY	DATE
NO.	20	APPROVED BY	DATE
NO.	21	APPROVED BY	DATE
NO.	22	APPROVED BY	DATE
NO.	23	APPROVED BY	DATE
NO.	24	APPROVED BY	DATE
NO.	25	APPROVED BY	DATE
NO.	26	APPROVED BY	DATE
NO.	27	APPROVED BY	DATE
NO.	28	APPROVED BY	DATE
NO.	29	APPROVED BY	DATE
NO.	30	APPROVED BY	DATE

KHAM CHUAN MARINE PTE LTD
 120 HILLMAN STREET, SINGAPORE 689228
 TEL: 67525288 FAX: 67527888
 WWW.KHAMCHUANMARINE.COM

50m MULTIPURPOSE OFFSHORE SUPPORT/ OIL SPILL RECOVERY VESSEL

GENERAL ARRANGEMENT			
NO.	1	APPROVED BY	DATE
NO.	2	APPROVED BY	DATE
NO.	3	APPROVED BY	DATE
NO.	4	APPROVED BY	DATE
NO.	5	APPROVED BY	DATE
NO.	6	APPROVED BY	DATE
NO.	7	APPROVED BY	DATE
NO.	8	APPROVED BY	DATE
NO.	9	APPROVED BY	DATE
NO.	10	APPROVED BY	DATE
NO.	11	APPROVED BY	DATE
NO.	12	APPROVED BY	DATE
NO.	13	APPROVED BY	DATE
NO.	14	APPROVED BY	DATE
NO.	15	APPROVED BY	DATE
NO.	16	APPROVED BY	DATE
NO.	17	APPROVED BY	DATE
NO.	18	APPROVED BY	DATE
NO.	19	APPROVED BY	DATE
NO.	20	APPROVED BY	DATE
NO.	21	APPROVED BY	DATE
NO.	22	APPROVED BY	DATE
NO.	23	APPROVED BY	DATE
NO.	24	APPROVED BY	DATE
NO.	25	APPROVED BY	DATE
NO.	26	APPROVED BY	DATE
NO.	27	APPROVED BY	DATE
NO.	28	APPROVED BY	DATE
NO.	29	APPROVED BY	DATE
NO.	30	APPROVED BY	DATE